

14\_ **AZURE**  
design STUDIO INDA





**AZURE**  
MOOD\_INDUSTRIAL STYLE

\_15

16\_AZURE







18\_ AZURE





20\_AZURE







Technical and aesthetic reach a new equilibrium, Azure the new dimension of Inda shower space.

Range of swing doors Frameless 8mm customized according to different proposals for handles and hinges, in a coordinated aesthetics with furniture and accessories Inda.

Hinges glued by UV technique, inner glass wire, new support bar, two retaining wall types, all for a shower sewn to measure the customer.

- Version with wall clamps
- Version with wall profile
- New standard handles and optional
- New hinge
- New hook support
- New support kit
- New wall profile
- New profiles door seal
- Profile breakwater
- Balloon seals
- 8 mm thick glass
- Inda Glass Protection optional
- Height 200 cm standard cabin.
- Max height 217 cm special cabin.



## FRAME

- AN Tipo cromato naturale lucido

## GLASS PANELS

- 01 trasparente 8mm.

## DETAILS

- Chromo

## HEIGHT SHOWER ENCLOSURES

- 200 cm. Standard
- 217 cm.max Special products

## MODELS

### Clamp wall version

- Door with a fixed component to corner with 4 doors
- Wing door with fixed element for niche
- Door with a fixed component to corner with fixed panel
- Fixed panel for swing door with a fixed element
- Hinged door with two fixed elements for niche
- Hinged door with two fixed panels to corner with fixed panel
- Fixed panel for swing door with two fixed elements

### Profile wall version

- Door with a fixed component to corner with 4 doors
- Wing door with fixed element for niche
- Door with a fixed component to corner with fixed panel
- Fixed panel for swing door with a fixed element
- Hinged door with two fixed elements for niche and corner with fixed panel
- Fixed panel for swing door with two fixed elements



## SPECIFICATIONS, PARTS AND ACCESSORIES

### STANDARD HINGE

- Material polished steel
- opening inside / outside
- lifted in the opening / closing with snap 90 ° position; beyond 90 ° the hinge allows the opening to approximately 120 °
- Glass fixing by UV bonding
- internal thread
- External cover zinc-alloy chromium
- screws in stainless steel



### OPTIONAL HINGE

- Material polished steel
- opening inside / outside
- lifted in the opening / closing with snap 90 ° position; beyond 90 ° the hinge allows the opening to approximately 120 °
- Glass fixing by UV bonding
- internal thread
- External cover zinc-alloy chromium
- screws in stainless steel
- finishes outer cover (see table)



SHINY GLASSES								MIRRORS		
TP521E	TP500E	TP520E	TP519E	TP523E	TP503E	TP534E	TP532E	S300	S301	S302
BLACK	WHITE	CRETE	CEMENT	GRAPHITE	MOON EARTH	HAVANA	BRUNO	MIRROR	SMOKED	BRONZE

### STANDARD HANDLE

- Finish: chrome
- Material: zama
- Screws: stainless steel
- Handle external / internal



### OPTIONAL HANDLES

- Finish: chrome
- Material: zama
- Screws: stainless steel
- Handle external / internal
- finishes outer cover (see table)



SHINY GLASSES								MIRRORS		
TP521E	TP500E	TP520E	TP519E	TP523E	TP503E	TP534E	TP532E	S300	S301	S302
BLACK	WHITE	CRETE	CEMENT	GRAPHITE	MOON EARTH	HAVANA	BRUNO	MIRROR	SMOKED	BRONZE

## WALL CLAMP

- closing caps
- carter for concealed chrome plated ABS
- new clamping system with screws
- extensibility and regulation of out of square 0 cm.



## WALL PROFILE

- Profile end caps
- aluminum screw caps crankcase
- new tilting gripper clamping system
- corner upright
- extensibility and regulation of out of square 2 cm.. acting with the clamps on the fixed glass

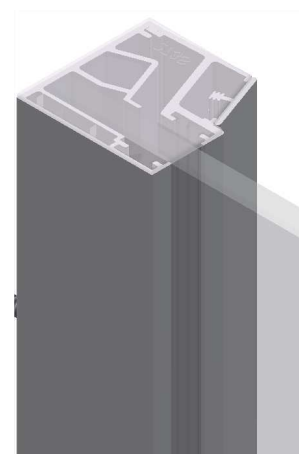

## EXTENSIBILITY AND REGULATION OF OUT OF SQUARE

- 2 cm. Extensibility
- obtained on the wall profile acting through the clamps on the fixed glass

## SUPPORT BRACKETS

- material: aluminum AN, chrome zama
- caps of ABS
- standard on all models



### PROFILES

- Finish: AN type natural shiny chrome
- Material: Aluminum
- compensating profile not provided



### GLASS PANELS

- Finish: 01 Transparent
- Tempered glass 8 mm.



### INDA GLASS PROTECTION (IGP)

- Optional

### BREAKWATER

- Finish: AN type natural shiny chrome
- Material: Aluminum
- caps of ABS
- standard on all models



### PORT PROFILE SEAL FOR MAGNETIC CLOSURE

- Finish: AN type natural shiny chrome
- Material: Aluminum
- glued to the glass
- internal glass thread
- end caps at the ends

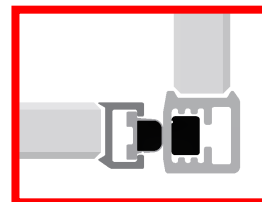
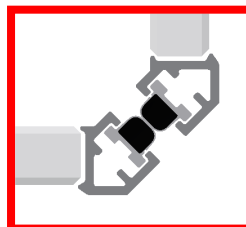

### PORT PROFILE SEAL FOR DRIP

- Finish: AN type natural shiny chrome
- Material: Aluminum
- glued to the glass
- in the glass thickness
- minimal low aesthetic impact

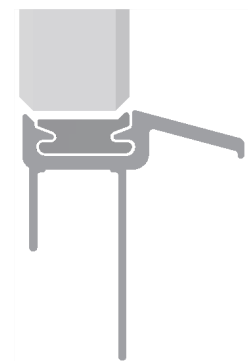

### SEALS

- magnetic
- balloon
- drip lower